





Delaware Towns Floor Plan

In Riverview Estates from \$467,400

PLAN DETAILS

Pricing from \$467,400

-  3 Beds
-  2.5 Baths
-  2,380 Sq Ft
-  2 Story
-  2 Car Garage



Delaware Towns
Rendering

Our Delaware Townhome design combines a convenient style of living with an elegant and spacious floorplan. Upon entering this home, a well located Family Foyer can be found around the corner leading to a Powder Room, Coat Closet, and entrance to the 2-Car Garage. Continue into the open living area to find a private Study and Formal Dining room that flow into the Great ... Read More at tuskeshomes.com

Delaware Towns Floor Plan

In Riverview Estates from \$467,400

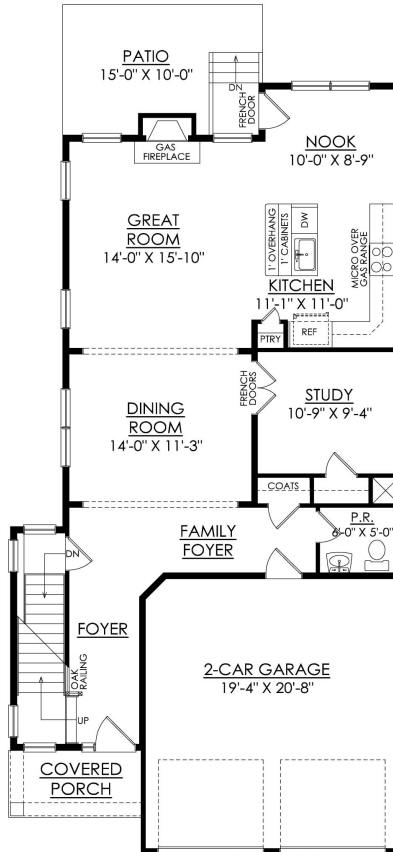

DELAWARE- 1ST FLOOR
STARTING AT 2380 SF

Delaware Towns Floor Plan

In Riverview Estates from \$467,400

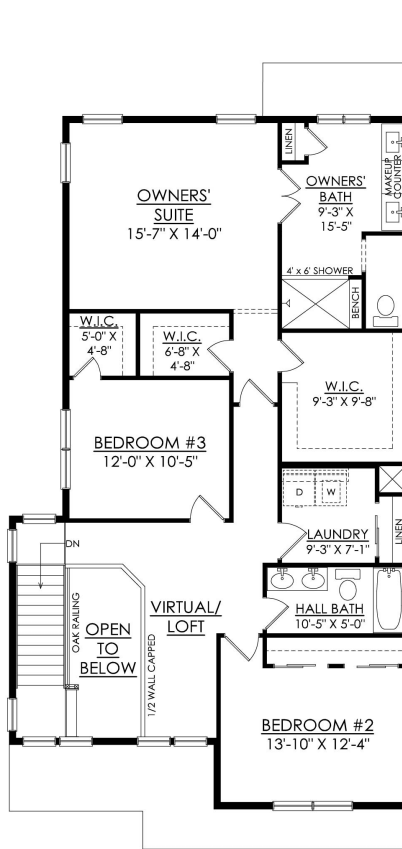

DELAWARE- 2ND FLOOR
STARTING AT 2380 SF