

Whitehall

Available in 1 Community

PLAN DETAILS

3 Beds 2.5 Baths 2,546 Sq Ft

3 Story 2 Car Garage



Craftsman - Side Entry

Step into luxury with The Whitehall, an impressively designed home featuring a stylish and unique 3-Story floor plan. Enter the 1st Floor through the convenient 2-Car Garage, and be greeted by the Family Foyer, a perfect place to keep your coats, shoes, and any other items out of sight. Enhance this floor by finishing the additional room and rough-in bathroom for an extra bedroom or workspace. Take the stairs to the 2nd Floor and be awed by the spacious Entry, Guest Foyer, and Great Room with stunning views of the covered front porch. The Great Room seamlessly flows into the chic Kitchen, equipped with a corner pantry and a large kitchen island with an undermount sink and overhang for seating. Entertain in style with a grand Dining Room or work from home in the private Study. Head to the 3rd ... Read More at tuskeshomes.com

PLAN FEATURES

- 3 Bedrooms
- 2.5 Bathrooms
- 2-Car Garage
- Starting at 2,546 Square Feet
- GE Granite or Quartz Kitchen Countertops
- Stainless Steel Range/Oven, Microwave, and Dishwasher
- Elevated Front Porch
- 2nd Floor Laundry Room
- Family Foyer on 1st Floor
- Guest Foyer on 2nd Floor
- Optional 4th Bedroom and Finished Bath on 1st Floor
- Private Owners' Suite

Whitehall

Available in 1 Community



Whitehall

Available in 1 Community

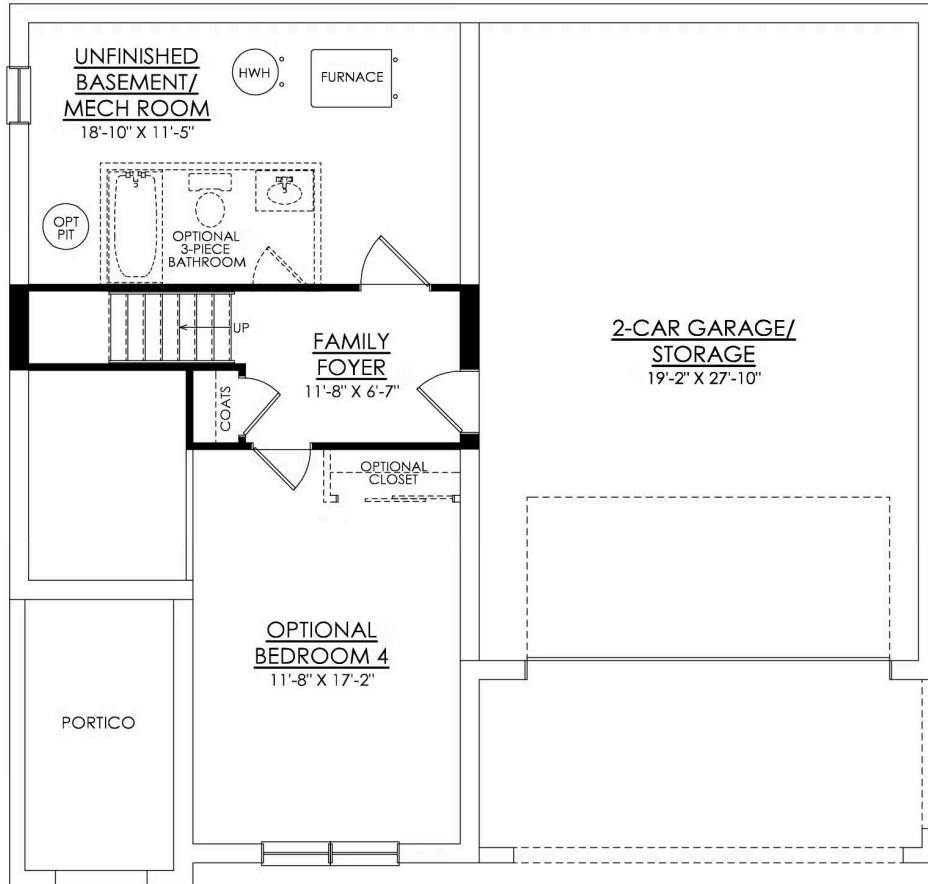

WHITEHALL TRADITIONAL STARTING AT 2546 SF 1ST FLOOR PLAN

Whitehall

Available in 1 Community

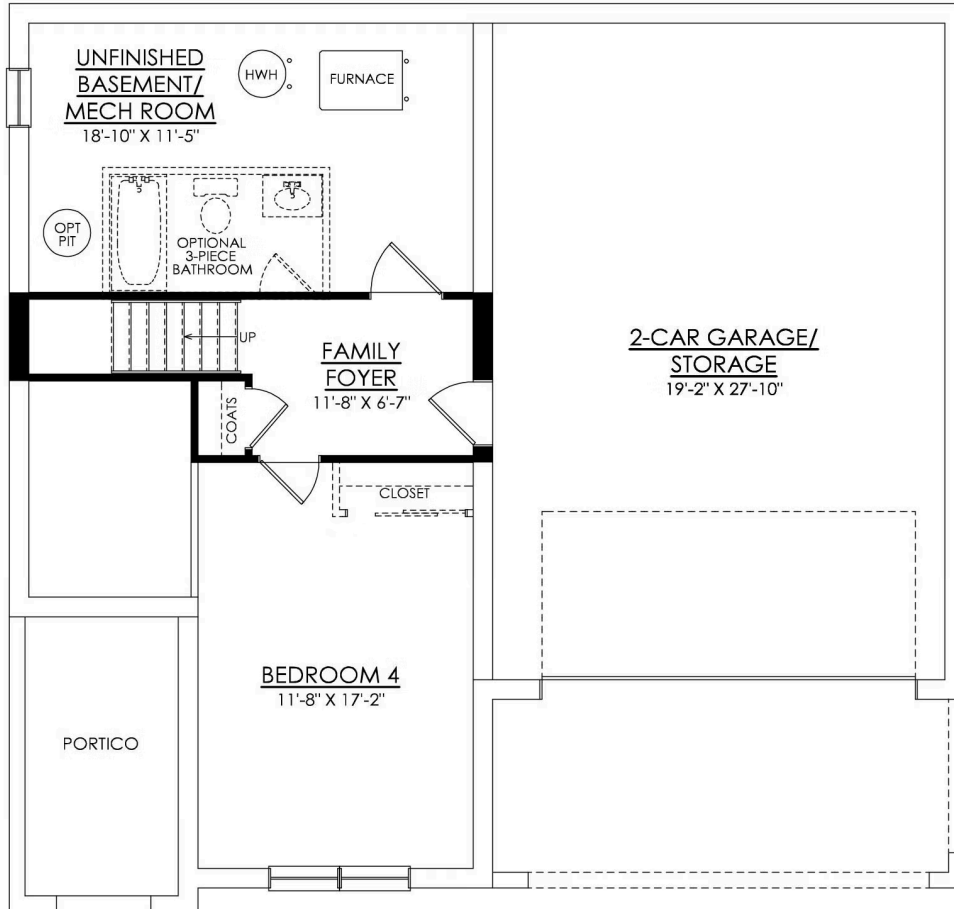

WHITEHALL TRADITIONAL STARTING AT 2546 SF 1ST FLOOR PLAN



Whitehall

Available in 1 Community



Whitehall

Available in 1 Community



Whitehall

Available in 1 Community



Whitehall

Available in 1 Community



Whitehall

Available in 1 Community



Whitehall

Available in 1 Community



Whitehall

Available in 1 Community



Whitehall

Available in 1 Community



Whitehall

Available in 1 Community



Whitehall

Available in 1 Community